

ALUK[®]
58BD HI
Entrance Door

POPULAR
RELIABLE
SECURE



Arkay Windows is a specialist large-scale fabricator with over 45 years experience based in Watford, North West London.

Through growth built on putting our customers first, we have risen to supply some of the country's biggest retail companies, contractors and commercial installers.

 **Arkay Windows**



01923 803 923

sales@arkaywindows.com

www.arkaywindows.com

 **Arkay Windows**

58BD HI ENTRANCE DOOR

Available in a wide range of styles and formats, our stylish aluminium Entrance door system is suitable for both light and medium-duty use. Designed with security and flexibility front of mind, every door in the range is available in single and double configurations making them ideal for almost any application.

PRODUCT FEATURES

- Certified under the Secured By Design scheme
- Multi-point locking mechanism
- Part L compliant for new build and replacement
- Intergrated deep head for trickle vents
- PAS24 Certified

OPTIONS

- Glazing 24mm – 40mm
- 58mm or 70mm frame depth
- Low threshold option
- Single, dual and anodised finishes
- Available in single or double door configuration
- Standard, Thumbturn & 3* cyclinders options
- Electric lock available
- Door Restrictors available



Meeting Stile Detail

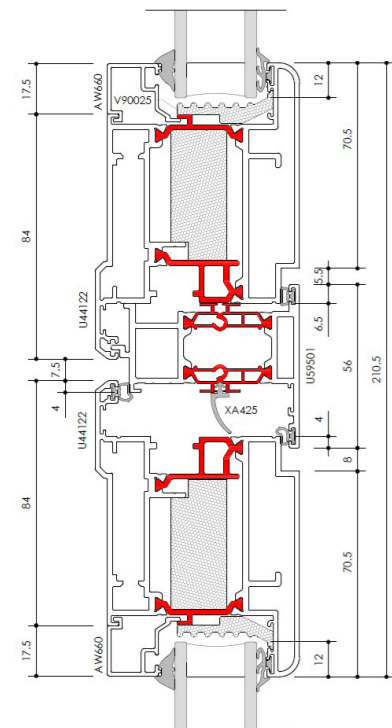

Cill Detail Low Threshold

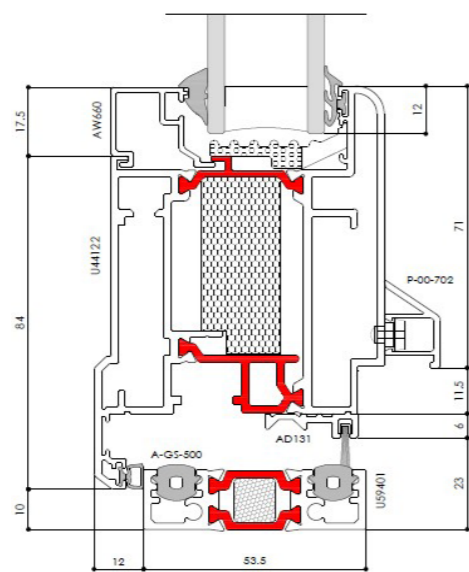

Cill Detail Standard Threshold

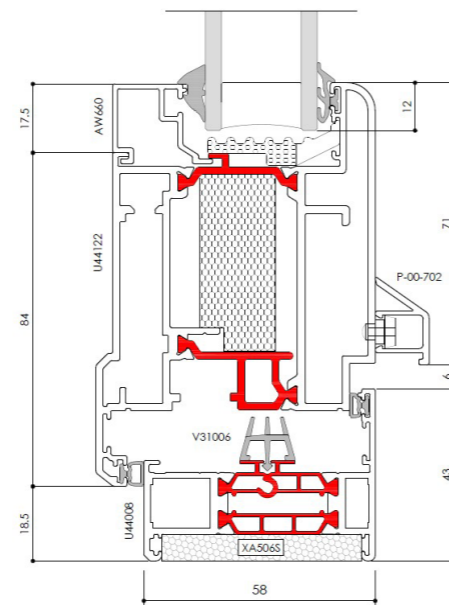

SPECIFICATIONS

PERFORMANCE & ACCREDITATION	SINGLE OPEN IN	SINGLE OPEN OUT	DOUBLE OPEN IN	DOUBLE OPEN OUT
Air permeability	Class 4 (600 Pa)	Class 4 (600 Pa)	Class 3 (600 Pa)	Class 3 (600 Pa)
Water penetration	Class 3a (100 Pa)	Class 7a (300 Pa)	Class 7a (300 Pa)	Class 9a (600 Pa)
Wind resistance	Class A3 (1200 Pa)	Class AE2400 (2400 Pa)	Class A3 (1200 Pa)	Class A4 (1600pa)
Building regulations part L	✓	✓	✓	✓
Building regulations part M	✓	✓	✓	✓
•U-value (double glazing)	1.3 W/m²K	1.3 W/m²K	1.3 W/m²K	1.3 W/m²K
†U-value (triple glazing)	1.1 W/m²K	1.1 W/m²K	1.1 W/m²K	1.1 W/m²K
3rd party certification	Q-mark	Q-mark	Q-mark	Q-mark
PAS24 Certified	✓	✓	✓	✓
Secured by design	Yes	Yes	Yes	Yes
Durability EN1191 category	50,000 Cycles	50,000 Cycles	50,000 Cycles	50,000 Cycles

DESIGN FEATURES

Minimum door leaf size	600mm x 1560mm	Sightline (Head)	120mm/130mm
Maximum door leaf size	1200mm x 2400mm	Low Threshold Sightline (Cill)	111 mm
Maximum door leaf weight	90 kg	Sightline (Jamb)	130mm
Maximum glazing thickness	24mm - 40mm	Sightline (Meeting Stile)	210 mm

CILL OPTIONS

90mm stub cill	150mm cill	180mm cill	230mm cill	300mm cill
----------------	------------	------------	------------	------------

APPLICATIONS

New build	✓	✓	✓	✓
Refurbishment	✓	✓	✓	✓

HANDLE OPTIONS



LEVER HANDLE	POLE HANDLE	PAD HANDLE
White lever/lever	1200 S/S Pole & Lever	White lever/pad
Black lever/lever	1200 S/S Pole In & Out	Black lever/pad
Grey lever/lever	1500 S/S Pole & Lever	Silver lever/pad
Silver lever/lever	1500 S/S Pole In & Out	Chrome lever/pad
Chrome lever/lever	1800 S/S Pole & Lever	Gold lever/pad
Gold lever/lever	1800 S/S Pole In & Out	
Dual lever/lever		
Lever/Blank Plate		

COLOURS

Standard Colours	RAL7016 Matt Grey	RAL 9005 Matt Black	RAL 9910 Gloss White
------------------	-------------------	---------------------	----------------------

We are able to manufacture in over 200 single, dual and anodised finishes to match your project

• U-Value (Double Glazing) - Single Doors are calculated using EN ISO 10077 - Part 2, 1000mm x 2180mm Single Door with Ug: 1.0 W/m²K using AW604 outerframe and AD200/AD201 vent. Double Doors are calculated using EN ISO 10077 - Part 2, 2000mm x 2180mm Single Door with Ug: 1.0 W/m²K using AW604 outerframe and AD200/AD201 vent.
 † U-Value (Triple Glazing) - Single Doors are calculated using EN ISO 10077 - Part 2, 1000mm x 2180mm Single Door with Ug: 0.7 W/m²K using AW604 outerframe and AD200/AD201 vent. Double Doors are calculated using EN ISO 10077 - Part 2, 2000mm x 2180mm Single Door with Ug: 0.7 W/m²K using AW604 outerframe and AD200/AD201 vent.